

## Phase 1 revision - NEXT GENERATION WING

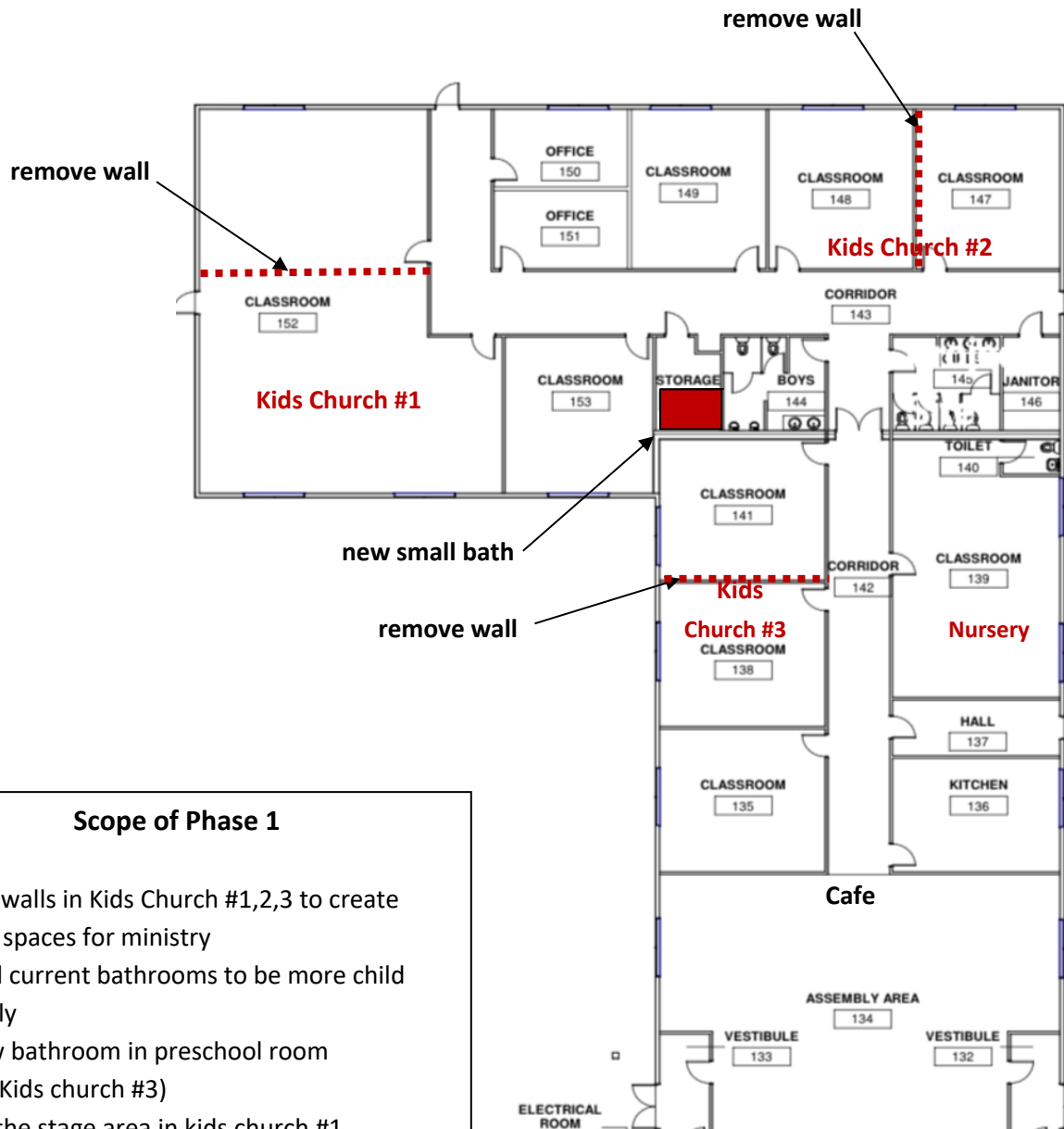

### Scope of Phase 1

- remove walls in Kids Church #1,2,3 to create larger spaces for ministry
- remodel current bathrooms to be more child friendly
- add new bathroom in preschool room (Kids church #3)
- rebuild the stage area in kids church #1
- repair electrical, lighting, and ceilings
- add a hand washing station in main hall
- repair old damage to walls
- install new flooring
- new paint throughout